

The Duluth
blueprint
for safety

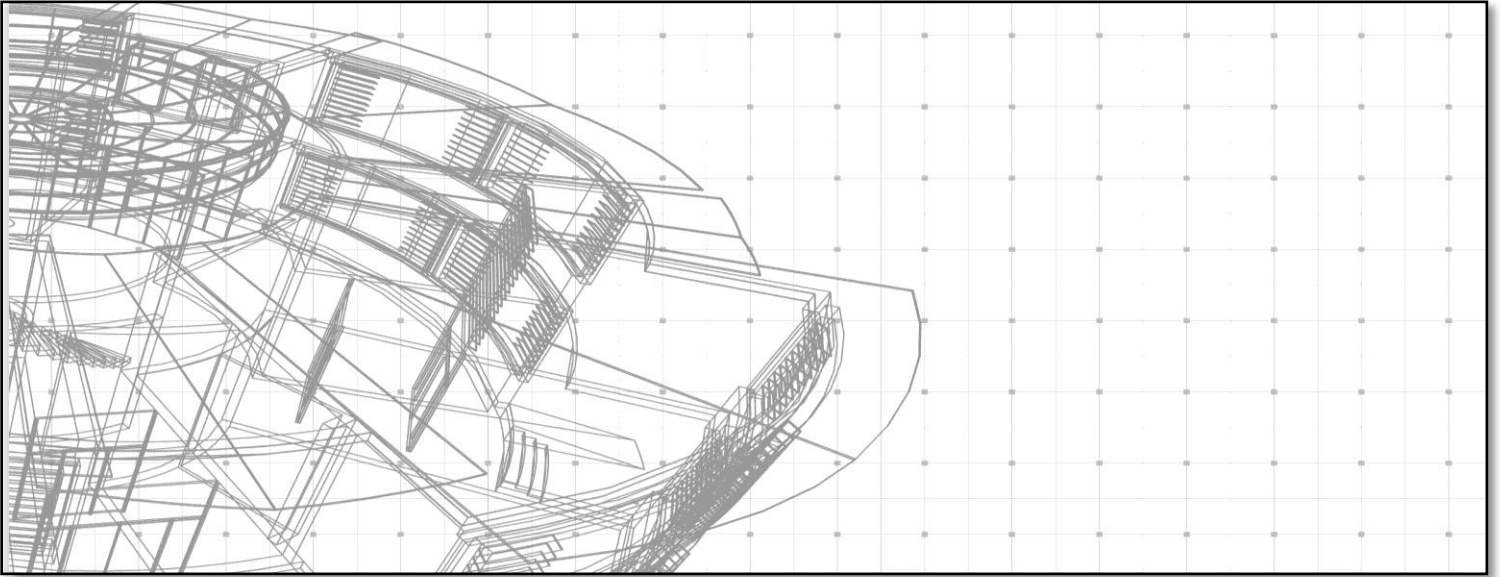

Adopted January 29, 2015
Adapted from the Saint Paul *Blueprint for Safety*

Policy Updates as of January 29, 2017

This project is supported by Grant No. 2011-WE-AX-K003 awarded by the Office on Violence Against Women, U.S. Department of Justice. The opinions, findings, conclusions and recommendations expressed in this document are those of the author(s) and do not necessarily reflect the views of the U.S. Department of Justice.

For information on the *Blueprint for Safety* initiative in Duluth:

Contact the Domestic Abuse Intervention Programs at 218-722-2781:
www.theduluthmodel.org

The Duluth *Blueprint for Safety* is available at:
www.theduluthmodel.org/duluth-blueprint-safety

For more information about the Saint Paul *Blueprint for Safety*, go to:

Saint Paul Domestic Abuse Intervention Project
www.stpaulBlueprintspip.org

For more information about the Office on Violence Against Women/Praxis International Demonstration Initiative and to access training, assistance, and materials, go to:

Praxis International
www.praxisinternational.org

The Duluth **blueprint** *for* safety

Archbishop Desmond Tutu tells us that justice demands three things: that the truth be told, that to whatever extent possible the harm be repaired, and that the conditions that gave rise to the injustice be forever altered.

The Duluth Blueprint for Safety is dedicated to all people whose bodies bear the marks of this injustice and to those who are committed to altering the conditions that give rise to this devastating form of violence, and to the late Ellen Pence, founder of the Duluth

Model method of organizing a community response to domestic violence. Ellen's mentorship and legacy continue to provide direction and insight into the very difficult work of making our community a safer place for victims of this crime.

We also want to acknowledge the Duluth and St. Louis County criminal justice agencies who for the past 35 years have demonstrated unprecedented commitment, creativity and courage to adapt their responses for the betterment of victims of battering.



City of Duluth
Don Ness, Mayor

411 West First Street • Room 403 • Duluth, Minnesota • 55802-1199
218-730-5230 • Fax: 218-730-5904 • Email: dness@duluthmn.gov • www.duluthmn.gov

An Equal Opportunity Employer

Foreword

In 1980, the City of Duluth embarked on what has become 35 years of work on improving our community for victims of domestic violence. The organizers and criminal justice professionals at the time could not have known how the ideas they generated would not only change Duluth, but the world. Today we celebrate a new chapter in our community's commitment to victims of domestic violence, but it is a day built on and made possible by a legacy started decades ago.

To put this achievement in perspective, we in government are used to new ideas and strategies that work for a time but are eventually replaced by the next new thing. This partnership between government and community agencies, which is the foundation of our coordinated community response, is one of those few strategies that have stood the test of time. To remain innovative and thus relevant for 35 years is an achievement. To be part of a strategy that continues to improve and be part of the national and international conversation on domestic violence over decades is remarkable.

The *Blueprint for Safety* was created by the City of St. Paul in partnership with Praxis International to advance the effort of coordinating the work of criminal justice agencies through policy and practice. In Duluth, this has meant improving the speed at which risk information gets collected, analyzed and shared from one agency to the next. Each agency, from 911 Emergency Communications to our local probation department has created or updated policy and practice in line with the best information we currently have about how to effectively intervene in domestic violence cases. The *Blueprint for Safety* project has been the impetus to institutionalize in policy many of the practices that have demonstrated their value to our overall response like specialized domestic violence units.

Duluth, Minnesota was chosen by the Office on Violence Against Women as one of three pilot sites to adapt the *Blueprint for Safety* created in St. Paul. New Orleans, Louisiana and Memphis, Tennessee along with Duluth will partner with St. Paul in advancing this work nationally. It is a credit to all these communities and to the people in them who advanced this work. In the end, it is about people in a community being open to change, believing they can do better, and prioritizing the safety of those who need help.

Ultimately, the motivation behind all this time and effort is to improve the safety of those brutalized by this form of violence. We have created interventions that have made it less likely that an abuser will continue to be violent. We have created interventions that document and share the experiences of victims for those making decisions so they can focus attention on the most dangerous offenders. We cannot rest as a community as long as there are members of our community who are in danger. This *Blueprint for Safety* has improved our work toward that goal.

Sincerely,

Don Ness
Mayor



Acknowledgments

The first three years of this project would not have been possible without the transparency, openness, trust and input from the criminal justice professionals working in Duluth, MN. Not since 1982 when nine agencies agreed to permanently institute previously experimental policies has there been such an investment in changing policy and practice among our criminal justice partners. Duluth's Coordinated Community Response operates at a level of expertise, commitment, and organization around domestic assault cases that is unprecedented in its history. Our coordinated effort has once again made good on its promise of improving safety for victims and holding offenders accountable.

Although the *Blueprint for Safety* is focused on the criminal justice system, the community advocates have been and will continue to be essential to the success of this project. The *Blueprint* aligns with the Duluth Model in that victims of battering must play a role in the work to coordinate our response. In the past 3 years, we have held over 20 focus groups with women to get their input on how to improve our efforts. Community advocates from Dabinoo'Igan Domestic Violence Shelter, Safe Haven Shelter and Resource Center, the Program for Aid to Victims of Sexual Assault (PAVSA), and the Duluth Family Visitation Center were critical in helping us find women willing to share their wisdom with our project. Also thank you to First Witness Child Abuse Resource Center for giving us the space to conduct focus groups and for helping us with them.

The advocates in our community played an essential role in taking time to talk through ideas, interventions, share their concerns and offer their support. Advocates hold the hurt, struggle and heart of the women and children they work with. The wisdom advocates have is nothing short of invaluable to a project trying to improve the response when victims call for help.

The Domestic Abuse Intervention Project (a project of Domestic Abuse Intervention Programs - DAIP) is a project focused on systemic interventions to improve the community's response for victims of battering. The DAIP was contracted by the City of Duluth to execute this project. System advocates spent hours observing practice, case processing, mapping systems, reading policy, protocols, practice guides, training manuals, etc. in an effort to first understand why a particular practice takes place. This learning is then brought into conversations with women experiencing violence about what it was like for them when they experienced that practice or what they imagine the problems the practice might create. DAIP staff then spent hours in partnership with criminal justice professionals coming up with solutions with the simultaneous goals of improving safety, accountability and the work experience and product of the practitioner. Although only two people were assigned to complete this project, every member of the team played an invaluable role.

Acknowledgments

The *Blueprint for Safety* was created in the City of Saint Paul in 2010 at the urging of ISALAH—a coalition of 100 faith congregations—and through the collective work of ten agencies with leadership by the St. Paul Police Department, St. Paul City Attorney’s Office, the St. Paul Domestic Abuse Intervention Project, and Praxis International.

Praxis subsequently produced a universal *Blueprint for Safety* for adaptation by communities across the country and was selected by the federal Office on Violence Against Women to implement the *Blueprint for Safety* Adaptation Demonstration Initiative (in partnership with the Battered Women’s Justice Project) to test the adaptability of the *Blueprint* in three jurisdictions: New Orleans, Louisiana; Shelby County/Memphis, Tennessee; and Duluth, Minnesota. Each site is adapting Blueprint policies and protocols to their local conditions and state laws; the lessons learned will be published at www.praxisinternational.org in 2015.

Office on Violence Against Women

A special thanks to the Office on Violence Against Women, U.S. Department of Justice, for the funding that supported this project, and for project guidance throughout.

Kevin Sweeney, Grant Program Specialist

Darla Sims, Grant Program Specialist

Technical Assistance

Praxis International provided technical assistance in adapting the Saint Paul *Blueprint for Safety*.

Denise Eng

Jane Sadusky

Cheryl Beardslee

Beverly Balos

Colia Ceisel

Julie Tilley

Maren Woods

Cyndi Cook

The Domestic Abuse Intervention Programs

The DAIP provided assistance and coordination to all project partners in drafting, researching and developing the enclosed policies. The DAIP also coordinated focus groups and administrated the grant on behalf of the City of Duluth, MN.

Melissa Scaia, Executive Director/Trainer

Scott Miller, *Blueprint for Safety* Co-Coordinator/CCR Coordinator/Trainer

Tara Haynes, *Blueprint for Safety* Co-Coordinator/System, Court, and Visitation Liaison

Patricia Goodman, DVRT/Men’s Nonviolence Program Coordinator

Jeff Fluguear, DAIN Coordinator/IT Support

Jill Abernathy, Women’s and Men’s Group Facilitator, DAIP

Alyxis Feltus, Native Women’s Advocate (Former)

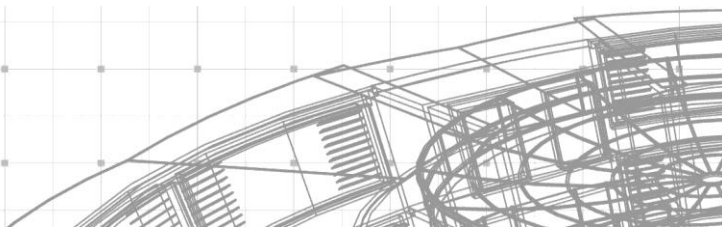

Criminal Justice Agencies

Each participating agency made its staff readily available to be observed, interviewed, and to engage in policy discussions and make recommendations. They also made their policies and forms available for review and change. Their cooperation and commitment to Duluth's Coordinated Community Response to domestic violence made the *Blueprint for Safety* possible.

The Duluth Police Department

Gordon Ramsay, Chief of Police

Ann Clancey, Deputy Chief of Police
Michael Ceynowa, Lieutenant,
Sex Crimes, Abuse and Neglect Unit (SCAN)
Sergeant Dana Putzke, SCAN Unit
Officer Adam Huot
Sergeant Tait Erickson
Officer Luanne Johnson

Lieutenant (retired) Kerry Kolodge
Investigator, Violent Crimes Dave Decker
Investigator Larry Westerman
Investigator Jill Kettleon

City of Duluth Prosecutor's Office

Gunnar Johnson, City Attorney

Mary Asmus, Assistant City Attorney
Joanne Piper-Mauer, Assistant City Attorney
Cary Schmies, Assistant City Attorney
Marcus Jones, Assistant City Attorney
Molly Pappas, VISTA Attorney
Dawn Anderson, Legal Administrative Assistant
Chelsea Helmer, Paralegal

St. Louis County Attorney's Office

Mark Rubin, County Attorney

Gary Bjorklund, Criminal Division Head
Jessica Fralich, Assistant County Attorney
Rebecca Stumme, Assistant County Attorney
Jon Holets, Assistant County Attorney
Kristin Swanson, Assistant County Attorney
Patty Wheeler, Director, Victim-Witness

St. Louis County Sheriff's Office

Ross Litman, Sheriff

Jail Administrator, Robyn Wojciechowski, St. Louis County Jail
Captain Mike Richards, St. Louis County Jail
Sergeant Jessica Pete, St. Louis County Jail
Patsy Kingsley, 911 Operations Manager
Ryan Stauber, 911 Dispatch

Acknowledgments

Stef Warnygora, 911 Dispatch
Lieutenant, Marcus Bruning (retired)
Director Steve Steblay, Homeland Security and Emergency Management
Lieutenant Dave Rolland, Court Services Division
Sergeant Chris Nylund, Court Services Division

Arrowhead Regional Corrections-Probation

Kay Arola, Director, Arrowhead Regional Corrections

Kathy Lionberger, Unit Supervisor, Duluth	Joshua Scheel, Probation Officer
Cassie Eliason, Probation Officer	Thomas Florestano, Probation Officer
Kelsey Johnson, Probation Officer	John Walker, Probation Officer
Michele Roenitz-Sigfrids, Probation Officer	
Becky Pogatchnik, Unit Supervisor, Northeast Regional Corrections Center	
Jen Wright, Superintendent, Arrowhead Juvenile Center	
Lynn Gagne, Unit Supervisor (Retired)	

The Sixth Judicial District Court and Court Administration staff gave their time and attention to the work of the criminal justice agencies involved in the *Blueprint for Safety*.

Sixth Judicial District Court and Court Administration

Honorable Judge Shaun Floerke, Chief Judge

Honorable Judge Sally Tarnowski
Honorable Judge Mark Munger
Honorable Judge Dale Harris
Marieta Johnson, Sixth Judicial District Administrator

The advocacy agencies below invested time, attention, feedback, review and recommendations to our work on the *Blueprint for Safety*. These agencies also invited women who had been battered to share their wisdom with the organizers of this project. Without their help, so much would not have been possible.

Safe Haven Shelter and Resource Center

Susan Utech, Executive Director

Heather Drees, Supervisor, Safe Haven Resource Center
Jen Davey, Community/Legal Advocate
Margo Colomb, Legal Advocate
Kaitlyn Beiese, Legal Advocate
Mary Kitterman, Legal Advocate

AICHO/Dabinoo'Igan Shelter for Battered Women

Michelle LeBeau, Interim Executive Director, AICHO

Janis Green, Shelter Director, Dabinoo'Igan

Patti Larsen, Gimaajii Program Coordinator
Michelle Pederson, Shelter Director, Dabinoo'Igan (Former)

Program for Aid to Victims of Sexual Assault (PAVSA)

Candice Harshner, Executive Director

Susan Terry, Criminal Justice Liaison

Katy Eagle, Attorney

First Witness Child Abuse Resource Center

Beth Olson, Executive Director

Frances Macaulay, Multi-Disciplinary Team Coordinator (Former)

Sara Lee, Family Advocacy Coordinator

The following individuals contributed their insight and expertise to the *Blueprint*:

Rhonda Martinson, Rhonda Martinson Consulting, LLC

Kristine Lizdas, Battered Women's Justice Project

Women's Advisory Committee was an essential component of our work. This group of women reviewed documents, shared experiences, authored text, gave insight and advised our work on the *Blueprint for Safety*. Their heartfelt commitment to improve our community's response on behalf of victims of domestic assault improved our work immensely. The following are the members of this committee who agreed to have their names listed. Thank you.

Amber Dean

Teresa Walter

Patti Larsen

Molly Harney

Leah Foster

Heather Jarvis

Lynette Blackburn

And those whose names are not listed, again, thank you.

The **Disparate Impact Advisors** were consulted to address the Blueprint foundational principal of avoiding unintended consequences and disparity of impact in the development of our Blueprint policies.

The following advisors to our project offered their expertise, insight and recommendations to the *Blueprint for Safety* regarding victims with a disability who experience domestic assault.

Laura Birnbaum, Advocacy and Family Services Director, ARC Northland

Erin Fontaine, Independent Living Program Manager, Access North Center for Independent Living in Northeast Minnesota

Amanda Crosby, Vocational Rehabilitation Liaison/Independent Living Skills Specialist,
Access North Center for Independent Living in Northeast Minnesota

Sandra Harrell, Vera Institute of Justice, Director, Accessing Safety Initiative

Acknowledgments

The following advised this project and offered their expertise, insight and recommendations to the *Blueprint for Safety* regarding juveniles arrested for an act of domestic assault against an abusive caregiver or parent.

Jen Wright, Superintendent, Arrowhead Juvenile Center

Babette Sandman, Juvenile Detention Alternatives Initiative (JDAI), Community Coach

Mark Rubin, County Attorney

Heather Drees, Supervisor, Safe Haven Resource Center

Melissa Scaia, Executive Director, DAIP and Advocates for Family Peace

Sue Lawson, Juvenile Detention Alternatives Initiative Coordinator

Mike Tusken, Deputy Chief, Duluth Police Department

John Nachtsheim, Initial Intervention Unit (Former)

Also an acknowledgement to all the young men who participated in focus groups and courageously shared their experiences.

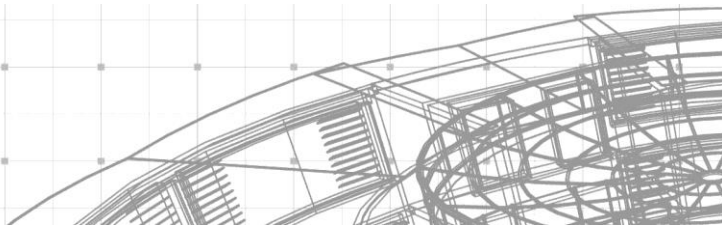

Table of Contents

Chapter One	Foundations of Effective Intervention
Chapter Two	911 St. Louis County Emergency Communications
Chapter Three	Law Enforcement Duluth Police Department
Chapter Four	Jail, Warrants and Court Security St. Louis County Sheriff's Office
Chapter Five	Prosecution Duluth City Attorney's Office St. Louis County Attorney's Office
Chapter Six	Victim Services St. Louis County Attorney's Office
Chapter Seven	Pretrial and Probation Arrowhead Regional Corrections, Duluth Office
Chapter Eight	Resource Materials
Chapter Nine	Bibliography

